

ARLINGTONSM

MEETING PLANNER GUIDE 2014 **2015**



Staff picks on
F&V local flavors.

Unique venues
make your event
memorable!

What can a
CVB do for you?

*If location is everything,
you're looking at
perfection.*



- 4 full-service hotels are 3 miles or less from the Arlington Convention Center
- Central location in United States
- 10 minutes from Dallas/Fort Worth International Airport
- Vibrant entertainment district with Six Flags Over Texas, Dallas Cowboys, Texas Rangers and much more

Visit ARLINGTON.ORG/MEETINGS to find out more about our award-winning Sales and Services Team and to submit an RFP.

817-265-7721 | sales@arlington.org



SHERATON
26,000 sq.ft. meeting space



HILTON
11,000 sq.ft. meeting space



CROWNE PLAZA
8,400 sq.ft. meeting space



HOLIDAY INN
3,100 sq.ft. meeting space



CONTENTS

2014 **2015**



Features

- 3 ACC Chef Spotlight
- 22 FAV Local Flavors
Staff Picks
- 24 After 5
- 25 TOP 10 Reasons why you should select Arlington for your next event

Spaces and Places

- 4 Arlington Convention Center
- 12 Full-Service Hotels
- 18 Select and Limited Service Hotels
- 20 Unique Venues
- 21 Event Venues

Major Venues

- 6 Globe Life Park
- 7 AT&T Stadium
- 8 Six Flags Over Texas
- 9 College Park Center
The University of Texas at Arlington

Planning Resources

- 2 Meet your Arlington CVB Team
- 10 Online Tools
- 11 Arlington CVB Services
- 16 Location is Everything
- 17 Hotel Locator Map



“Using a CVB can save you time and money... plain and simple. We exist to make your planner jobs easier.” — Joe Bedsole,
Director of State & Southwest Associations



The Arlington Meeting Planner Guide is a publication of the Arlington Convention & Visitors Bureau. Contents and design ©2014, all rights reserved. Reproduction without written permission is strictly prohibited. Every effort was made to ensure accuracy of the information in this guide as of press time. However, the Arlington Convention & Visitors Bureau assumes no responsibility for errors, changes or omissions.

The Arlington Convention & Visitors Bureau (“ACVB”) makes no endorsement, representation or warranty regarding the suitability, quality or availability of any goods or services advertised or listed in this publication. Listings and advertisements are provided by the subject companies, and ACVB shall not be responsible or liable for any inaccuracy, omission or infringement of any third party’s rights therein, or for personal injury or any other damage or injury whatsoever.





MEET *the Sales & Services Team*

OUR AWARD-WINNING Sales and Services team members offer professional attention and multi-faceted industry knowledge when you plan your meetings and events of all sizes in Arlington. Our experts are at your service and dedicated to your success.

SALES TEAM



JON HIXON, CMP, CTA
Vice President, Sales

○ 817-704-7588
C 817-897-6844

jon@arlington.org



DAVID LAW, CTA
Senior Director
National Accounts

○ 817-704-7578
C 817-343-9549

david@arlington.org



ELLEN BROWN, CTA
Director of
National Accounts

○ 817-704-7571
C 817-889-6924

ellen@arlington.org



JOE BEDSOLE, CTA
Director of State &
Southwest Associations
Austin Regional Office

C 512-656-4229

joe@arlington.org



MATT WILSON
Director of Sports &
National Accounts

○ 817-704-7585
C 817-673-2248

matt@arlington.org



STEFANIE SHAFNER
Executive Meetings
Specialist

○ 817-704-7592
C 817-504-1372

stefanie@arlington.org



APRIL LUTER, CTA
Tourism Sales
Manager

○ 817-704-7570

april@arlington.org



KELLY BUMGARNER, CTA
Conventions Sales
Administrative Assistant

○ 817-704-7583

kelly@arlington.org

SERVICES TEAM



MARY GERMAN, CMP, CDME, CTA
Vice President,
Services & Programs

○ 817-704-7580
C 817-729-7580

mary@arlington.org



CATLIN HOPSON, CTA
Convention Services
Coordinator

○ 817-704-7619

catlin@arlington.org

“The Texas Girls Coaches Association has been working with the Arlington Convention & Visitors Bureau every even year since 1988. TGCA is very appreciative for the guidance and service presented to us in a warm, congenial and sincere manner. We feel, through the efforts of the Arlington CVB, we are a part of the Arlington family. Our coaches look forward to coming to Arlington, because the hotels, convention center, restaurants, and entertainment venues make them feel special. We cherish our relationship with the Arlington CVB.”

– Sam Tipton, Executive Director
TEXAS GIRLS COACHES ASSOCIATION



Chef Spotlight

Robert Stehlin
Executive Chef, ACC
Culinaire International



with
Laurie Dove
Texas
Meetings +
Events

A

After experiencing some of the most impressive convention center cuisine we've ever encountered, Texas Meetings + Events sat down with Executive Chef Robert Stehlin of Culinaire International, who has been serving fine fare at the Arlington Convention Center for more than 14 years.

Catering for large groups isn't normally thought of as leading-edge cuisine.

Our philosophy on cooking at the ACC is to cook with as many fresh ingredients as possible. Our kitchen is 90 percent from scratch. We make our own sauces, vinaigrettes and use only fresh chicken and beef. We also use small amounts of expensive ingredients such as truffle oil, saffron, fresh microgreens, exotic fruits and heirloom tomatoes.

How has the Arlington Convention Center set itself apart, in terms of catering? How will it continue to do so?

We have a very dedicated and longterm staff with a commitment to personal service. Their years of experience and consistent efforts to always seek new and innovative menu items are a major asset. For example, we are often a less expensive alternative to hotels and competing convention centers, while still providing innovative items like our gourmet popcorn station. Plain popcorn is made exciting by tossing it with dill truffle oil, jalapeño cheddar butter, bacon blue cheese butter or cinnamon and sugar. Then it is served from vintage popcorn carts at an action station.

What's the best food you've ever eaten (prepared by the ACC's catering staff, of course)?

We recently hosted a baseball themed event. The client was looking for something fun that fit the theme but that was still upscale. I created a lobster corn dog served with a whole grain mustard hollandaise and filet mignon. It was really exceptional and the guests loved it too.

Chef Robert's Famous

~ BREAD ~ PUDDING

9x11 cake dish

6 Croissants, 1 Loaf French Bread or Brioche

} Cut into 2x2 cubes – enough to fill cake dish

CUSTARD: 1 quart heavy cream, 12 whole eggs
1 cup sugar, 2 tsp vanilla, 1 tsp cinnamon

Mix eggs and sugar together until smooth.
Add cream, vanilla and cinnamon – combine well.

STREUSEL TOPPING: 1 stick butter, ½ cup flour,
½ cup brown sugar – cut butter into flour and brown sugar mixture until crumbly.

DIRECTIONS: Let the bread dry uncovered on a sheet pan for one day. Butter the cake dish and place the bread evenly in the cake dish. Cover the bread with mixed custard. Let the pudding sit for one hour in the refrigerator. Cover the pudding with foil and place in the middle of an oven that has been preheated to 350 degrees. Bake for 45 minutes. Uncover, sprinkle the streusel topping on top and bake uncovered for an additional 15 minutes.

CRÈME ANGLAISE: 12 egg yolks, 1 cup sugar,
1 quart heavy cream, beans from 1 vanilla bean

Heat the cream and vanilla bean to a soft boil. While the cream is heating, whip the sugar and eggs together on medium speed until well combined and fluffy. When the cream is at a soft boil, gradually stir half of the cream mixture into the sugar and egg mixture. Once the sugar and egg mixture is tempered, combine it with the remaining cream mixture. Return to the stove and stir constantly over medium heat until it coats the back of a wood spoon and you can draw a line in the crème and it stays. Place the crème anglaise in the refrigerator until cool. Pour over warm bread pudding and serve immediately. ~

ARLINGTON CONVENTION Center



“We have been using the ACC every year since 1999. You can rent a building anywhere. But to get a top notch facility, with the most excellent staff, you have to come to Arlington! The ACVB Team know us and treat us like family.”

— Dudley Chancey, OKLAHOMA CHRISTIAN UNIVERSITY



>>> PHOTO: Dan Pope

**TOP
10
ACC
FACTS**

- 1. Located** in the heart of the Arlington Entertainment District
- 2. Designed** for ease of access for efficient set-up and teardown
- 3. Built to handle** significant electrical, utility and communications needs
- 4. Dramatic views** of AT&T Stadium, Six Flags Over Texas and Globe Life Park
- 5. 90,000 sq.ft.**, all on one level, including Exhibit Hall, Grand Hall, and Meeting Rooms
- 6. Free public wifi** available throughout the facility
- 7. Beautiful** walking trails around the ACC
- 8. 10 minutes from** DFW International Airport
- 9. Award-winning** chef and catering
- 10. Open space** 50,000 sq.ft. of column-free exhibit floor



ARLINGTON CONVENTION Center

THE GRAND HALL

30,000 sq.ft. of flexible, column-free carpeted space that provides an impressive backdrop and is divisible for banquets, meetings and events.

- 6,000 sq.ft. indoor pre-function gallery
- Outdoor waterfront terrace
- 30-foot ceilings
- More than 100 hang points
- Separate three bay truck dock

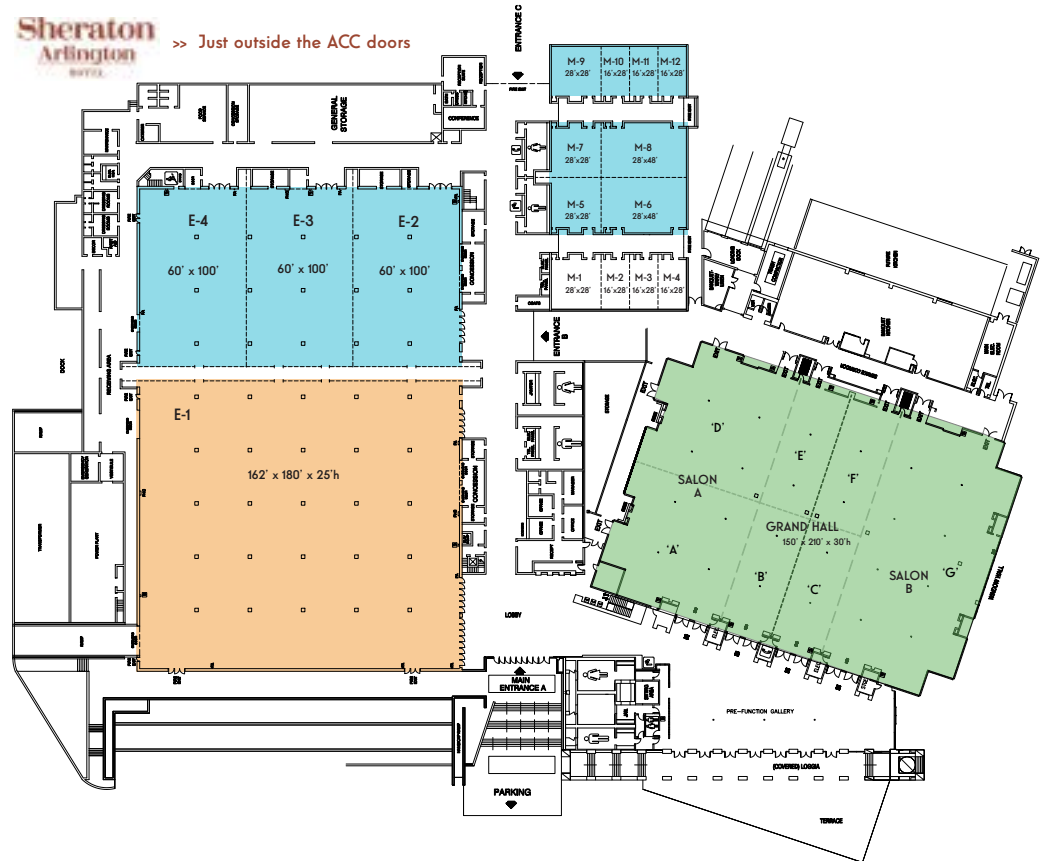

THE EXHIBIT HALL

48,600 sq.ft. of column-free space for up to 276 10'x10' booths, seating for 5,000 theater-style or 2,800 in a banquet format.

- 30-foot utility centers throughout the show floor
- More than 1,000 pounds per sq.ft. floor load factor
- Two drive-in access doors
- Separate six bay truck dock
- Expansive 25-foot ceilings

GRAND HALL	Function Room	Square Feet	Ceiling Height	Theatre	Classroom Seating	Banquets	Exhibit Booths 10 x 10
	Grand Hall	30,000	30'	3,000	1,500	1,800	150
	Salon A	15,000	30'	1,500	650	770	70
	Salon B	15,000	30'	1,500	650	770	70
	Gallery	6,000	22'				
	Terrace	4,700					

EXHIBIT HALL	Function Room	Square Feet	Ceiling Height	Theatre	Classroom Seating	Banquets	Exhibit Booths 10 x 10
	E- (1-4)	48,600	25'	5,000	3,900	2,800	276
	E-1	29,160	25'	2,800	2,400	1,500	157
	E-2	6,000	25'	670	500	320	32
	E-3	6,000	25'	670	500	320	32
	E-4	6,000	25'	670	500	320	32

MEETING ROOMS

Complementing the Exhibit Hall and the Grand Hall is an additional 8,500 square feet of divisible meeting space available for breakout sessions or smaller meetings. Up to 12 separate meeting rooms, each offering individual climate, lighting and sound controls. Also available are dedicated internet and telephone services.

MEETING ROOMS	Function Room	Square Feet	Ceiling Height	Theatre	Classroom Seating	Banquets
	M1	784	10'	72	40	48
	M2	448	10'	49	30	24
	M3	448	10'	49	30	24
	M4	448	10'	48	30	24
	M5	784	12'	72	40	48
	M6	1,344	12'	144	80	96
	M7	784	12'	72	40	48
	M8	1,344	12'	144	80	96
	M9	784	10'	72	40	48
	M10	448	10'	49	30	24
	M11	448	10'	49	30	24
	M12	448	10'	48	30	24



GLOBE LIFE *Park*

PHOTO: Dan Pope



FACT The 48,114-seat open-air ballpark offers guided tours through the batting cages, press box, dugout and more.

GLOBE LIFE PARK IN ARLINGTON, HOME OF THE TEXAS RANGERS, offers more than just championship baseball. With flexible indoor and outdoor spaces, renowned cuisine, this extraordinary venue is a stunning backdrop for any event.



- ✦ Corporate Outings
- ✦ Seminars
- ✦ Trade Shows
- ✦ On-Field Events
- ✦ Team Building
- ✦ Job Fairs
- ✦ Concerts
- ✦ Cocktail Parties
- ✦ Luncheons
- ✦ Races
- ✦ Weddings



VENUE CAPACITY

BASEBALL HALL OF FAME | 6,500 sq.ft.

Level One	200	350	300
Level Two	200	300	50
Level Three	200	350	200

THEATER

235	N/A	235
-----	-----	-----

JACK DANIEL'S CLUB | 17,000 sq.ft.

500	1,000	250
-----	-------	-----

CAPITOL ONE CLUB | 9,100 sq.ft.

Top Tier	160	200	200
Bottom Tier	90	215	50

HYUNDAI CLUB

80	150	100
----	-----	-----

CAPTAIN MORGAN CLUB | 4,000 sq.ft.

Level One	120	200	125
Level Two	130	200	125

BUDWISER BOWTIE PLAZA

Inquire

FIELD RENTAL

Inquire

KID ZONE

Inquire

CONCOURSE

Inquire

GRAND SLAM - ADD EXTRA TO YOUR EVENT WITH:

- ✦ Ballpark Tours
- ✦ Rangers Mascot "Captain" Appearance
- ✦ Six Shooter Appearance
- ✦ Alumni Player Appearance
- ✦ Rangers Merchandise
- ✦ Audio/Visual Setup
- ✦ Scoreboard Message
- ✦ Field Lights
- ✦ Valet Parking
- ✦ Batting Practice
- ✦ Pop flies in the Outfield
- ✦ On-field Banquet



ARLINGTON.ORG/MEETINGS | 817-265-7721
sales@arlington.org

AT&T Stadium

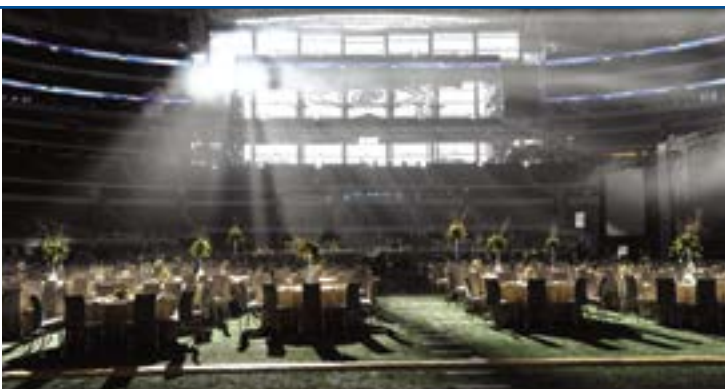

FACT Available guided art tours share the unique collection of museum quality contemporary art within the Stadium.

LET THE OPULENTLY COLOSSAL AT&T STADIUM host your next event. This \$1.3 billion venue was built to impress and is the epitome of Texas-sized hospitality. More than 22 flexible event locations provide the perfect setting, specific to your event needs.

EVENT SPACE

FIELD | 98,000 sq.ft. Home of the Cowboys Star. Retractable roof. Direct access to load-in, load-out. Full Power available. 10 x 10 Booth Capacity: 490

5,000 2,500 2,000 REQUEST REQUEST

MILLER LITE CLUB | 9,300 sq.ft. Experience the excitement of having your event in a room directly adjacent to the Field.

350 220 184 150 51

CLUB LITE | 9,300 sq.ft. Adjacent to the Field on the Visitor's side of the stadium.

350 220 184 150 51

COWBOY'S LOCKER ROOM | 2,400 sq.ft. Evening only 6:30 pm start Work on your own team strategy, inspire and motivate your guests by meeting in the Cowboys Locker Room.

150 120 72 125 60

POST-GAME INTERVIEW ROOM | 2,700 sq.ft.

150 120 72 150 80

HALL OF FAME LEVEL

**INFORMATION TECHNOLOGY AMPHITHEATRE
INFORMATION TECHNOLOGY CONFERENCE ROOM**

MAIN CONCOURSE

MAIN LEVEL CLUB SOUTH | 30,000 sq.ft.

2,500 400 344 130 135

MAIN LEVEL CLUB NORTH | 33,000 sq.ft.

2,500 740 704 150 216

AT&T ENDZONE EAST | 24,500 sq.ft. Panoramic platform view overlooking the field as well as the water feature in the East Plaza.

2,500 780 720 1300 498

AT&T ENDZONE WEST | 24,500 sq.ft. Panoramic Platform view overlooking the field and a view of downtown Fort Worth

2,500 780 720 1300 498

SILVER LEVEL

AMERICAN AIRLINES LOUNGE | 8,700 sq.ft. Vaulted ceilings with spacious surroundings.

500 250 208 150 90

SONY LOUNGE | 8,700 sq.ft. Experience the Silver lining near the top of the stadium. This club has a view of the skyline.

500 250 208 150 90

FORD ENDZONE | 14,500 sq.ft. East side End Zone Platform, Silver level Reception 350

MILLER LITE ENDZONE West side End Zone Platform, Silver level Reception 350

STAR LEVEL

MEDIA PRESS BOX | 3,500 sq.ft.

200 100 64 100 75

UPPER CONCOURSE LEVEL

DR PEPPER ENDZONE | 14,000 sq.ft. Highest level, amazing view, East side

500 300 256 N/A N/A

PEPSI ENDZONE | 14,000 sq.ft. Highest level, amazing view, West side

500 300 256 N/A N/A

UPPER CONCOURSE EAST ANNEX BAR | 2,400 sq.ft.

150 100 N/A N/A N/A

BACARDI BAR | 2,400 sq.ft.

150 100 N/A N/A N/A

KEY: RP = RECEPTION, BQ-10 = BANQUET

BQ-B = BANQUET, TH = THEATRE, CR = CLASSROOM

sales@arlington.org



SIX FLAGS *Over Texas*



FACT

Six Flags Over Texas is the original Six Flags Theme Park, opening on August 5, 1961.

THE MORE THE MERRIER! Six Flags is in the business of fun, so why have your event anywhere else? Options abound for many groups. Explore options like special pricing, two private and covered pavilions, meal vouchers, even personalized tickets with your company name on them. The picnic pavilions and indoor show venues can serve as meeting sites, complete with audio/visual set-up.



GROUP SIZE

Six Flags Over Texas features several venues options for groups looking for out of the box meeting locations.

Indoor theaters vary in seating capacity and style. Subject to availability.

• Crazy Horse Saloon	250
• Lone Star Theater	350
• Majestic Theater	850
• Southern Palace	930
• Music Mill	9500

Outdoor picnic pavilions are also available and seat 1000.

AV Requests

- Set up and technical support available. AV fees vary by request.
- PA system available in pavilions at no additional charge

• Venue access requires park admission. 100 ticket minimum group size.

YOU BRING THE TEAM... WE'LL BRING THE SCREAM!

- 212 acres of excitement
- 44 rides
- 12 roller coasters
- 5 water rides
- Live Shows
- Top-Tier Entertainment
- Catered Meetings
- Great group rates



ARLINGTON.ORG/MEETINGS | 817-265-7721
sales@arlington.org

THE UNIVERSITY OF TEXAS AT ARLINGTON

COLLEGE PARK Center

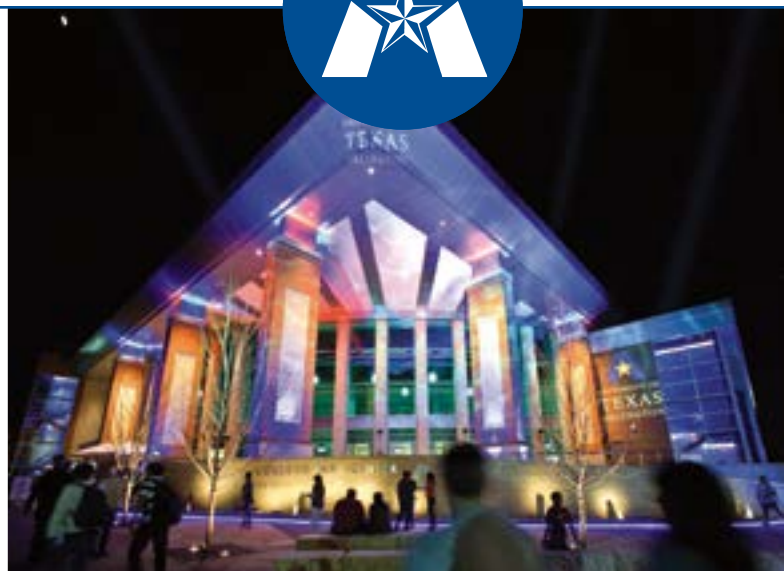

FACT The U.S. Green Building Council recognized College Park Center with a LEED Gold certification.

OUR NEW HOME COURT Designed as a home for three of UT Arlington's Division I teams, College Park Center can easily accommodate a variety of athletic competitions: basketball, volleyball, wrestling, cheerleading, plus dance and martial arts events.

BUILT FOR BUSINESS College Park Center's size and location in Arlington's downtown business district make it a perfect place for corporate events, including:

- Conferences
- Trade shows
- Training sessions
- Orientations
- Product launches



PARTIES DONE RIGHT The arena and Hospitality Suite are available for private parties, corporate functions, receptions, and special occasions. We'll also help you plan your event, everything from designing the room layout and securing audio and video equipment to choosing the menu and cleaning up afterward!

SPECIFICATIONS

LAYOUT

- 12,000 sq.ft. arena floor (8,400 sq.ft. sports configuration)
- Seating for up to 7,000 for sporting events
- Seating for up to 6,300 for concert/stage events
- Portable 120' x 60' basketball floor
- Accommodates 120 (8' x 10') booths

A/V COMPONENTS

- Daktronics end hung video board (14' x 25' LED video screen)
- Daktronics four-sided center-hung video board
- Two 200-amp and four 400-amp electrical services at floor level (Stage Right)
- One 200-amp electrical service at catwalk level
- Full broadcast and video production capabilities
- Wireless Internet

AMENITIES

- Two practice courts (7,700 square feet each)
- 2,800-square-foot Hospitality Suite, divisible into three sections
- Full concessions and catering services
- Three dock bays, one drive-up truck dock
- Back of house accommodates 25 cars, eight trucks or seven buses



ONLINE Tools

IF YOU'RE LOOKING TO HOST an annual meeting, conference, reunion or activity in Arlington, there will be lots to do before the big event! Visit our website and you'll find planning tools that are just a click or two away.



ARLINGTON.ORG/MEETINGS

- The Meeting Planner section of our website is devoted to making your job easier.
- Meet the experienced sales and services team members that will assist you.
- Initiate a quick search to see what Arlington venues will work for you.
- Check out our "Meeting Pros Tool Kit" for updated information and new tools!
- Submit an RFP or email our team for a personal consultation at sales@arlington.org or

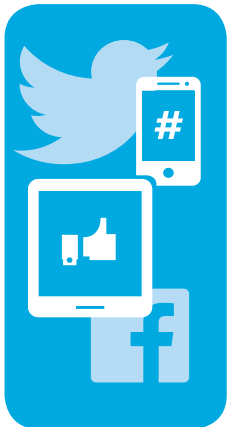

HOW CAN YOU GENERATE BUZZ AND BUILD YOUR ATTENDANCE?

- **GET SOCIALLY SAVVY** Spread the word through your social media like Facebook and Twitter. Tag us in your posts and tweets.
- **ONLINE/WEBSITE** Update event info. Is your early bird discount beginning or ending? What room block(s) at which hotel(s) did you establish through the Sales and Services Team at the Arlington CVB? What clothing should people pack for your newly-booked evening event? Link to the CVB's "Things to Do" pages. These are all things that your guests will WANT to know.
- **COMPANY INTRANET** If you have a company intranet, don't neglect it! This is the perfect vehicle for keeping staff members informed about important announcements and registration for your event.

“A good CVB is a remarkable support system. Arlington has taken the time to learn about TASC. They support us, and they have developed a real relationship. They take the time needed to do that. I love it that they are passionate about their city, that they partner with us, and that they care about our success. If you don't use a CVB, you just added hours to your job.”

- Terry Hamm, Director, Texas Association of Student Councils





ARLINGTON CVB *Services*

OUR AWARD-WINNING SALES & SERVICES TEAM

is dedicated to customer service. We guide clients through the planning process with meticulous care and personal attention to detail. Whether you are coordinating a large convention or a small meeting, we offer efficient planning tools to make the process easier. Many services are complimentary to planners that utilize Arlington hotels.

Need access to tour guides, speakers, trade show services, printers, flowers, premium items, caterers or entertainment? We can get you to the reliable resources and partners that you need for success.

- Customized Bid Books
- Lodging Blocks
- Spouse Activities
- Arlington Trolley/Guest Transportation Coordination (based on room nights)
- Offsite Activity Planning Assistance
- VIP and Corporate Responsibility Programs
- Guest Speakers and Entertainment Coordination
- Public Relations Assistance
- Site Visits and FAM Tours
- Volunteer Services
- Attendance Promotions



Mary German
CMP, CDME, CTA

mary@arlington.org
817-704-7580

VP OF BUREAU SERVICES & PROGRAMS

is a respected 27-year industry veteran and a customer service guru. The team has honored requests for everything from boxing kangaroos to special parade permits. If they can handle all of this, just think what they can do for you! She is a legend in the hospitality industry because she uses her endless energy, creative ideas, and loyal connections to benefit her clients.

Industry Achievements:

- Certified Meeting Professional (CMP) Facilitator
- Certified Destination Management Executive (CDME)
- Destination Marketing Association International (DMAI) Advocacy Committee Resource Development Chair
- International Association of Events & Exhibitions (IAEE)
- Event Services Professional Association (ESPA)
- Advocacy Committee Resource Development Chair
- Lifetime member of the Texas Alliance of Convention Meeting & Event Operations Managers (TxACOM)
- Certified Tourism Ambassador Facilitator (CTA)

Awards:

- 2012 Texas Girls Coaches Association, Margaret McKown Distinguished Service Award
- First recipient of the TXACOM GAMMA Award
- Outstanding Club Officer for Toastmasters International Division D, District 25

“The Arlington CVB is the Siri of the City.”



Catlin Hopson
CTA

catlin@arlington.org
817-704-7619

CONVENTION SERVICES COORDINATOR

is one of the brightest stars in the business. Catlin's commitment to excellence and attention to detail ensure outstanding client experiences, while her warm smile and infectious positive attitude create a lasting first impression, laying the groundwork for long-term relationships.

Industry Achievements:

- Texas Alliance of Convention, Meeting & Operations Managers (TxACOM) Board of Directors
- Event Service Professionals Association (ESPA) Annual Meeting Planning and Sustainability Committee
- Texas Association of Convention & Visitor Bureaus (TACVB)
- TxMet Advisory Council
- Certified Tourism Ambassador Facilitator (CTA)



SHERATON *Arlington*



1500 Convention Center Drive



ARLINGTON.ORG/MEETINGS

QUICK INFO

MEETING ROOMS

18

SQ.FT. EVENT SPACE

26,000

TOTAL ROOMS/DOUBLES

311/143

MILES TO ACC MILES TO DFW AIRPORT

0

9

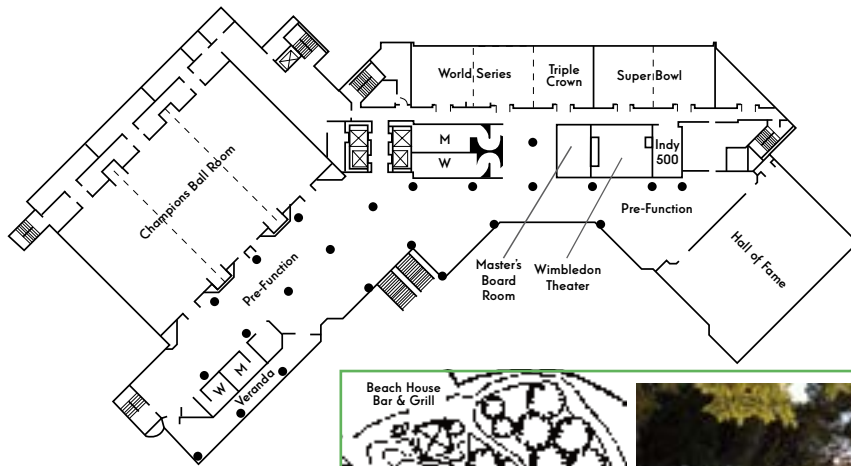

Plaza on the Hill

Our private outdoor meeting space, adjacent to the pool, features a private Yacht Club and 4,300 sq. ft. of space capable of seating accommodating up to 500 guests.



MEETING ROOM	DIMENSION	SQ. FT.	CEILING	RECEPTION	BANQUET	THEATRE	CLASSROOM	CONFERENCE	U-SHAPE
Champions Ballroom (total)	100'x60'	6,000	14'	700	500	675	350	N/A	N/A
Champions I, II & III (each)	33'x60'	1,980	14'	225	150	220	120	50	40
Hall of Fame	68'x48'	3,264	12'	250	200	300	150	40	40
World Series (total)	51'x25'	1,275	9'	115	80	100	60	40	40
World Series I & II (each)	25'x25'	625	9'	50	40	50	30	20	20
Triple Crown	25'x25'	625	9'	60	40	50	30	20	20
Super Bowl (total)	51'x25'	1,275	9'	115	80	100	60	40	40
Super Bowl I & II (each)	25'x25'	625	9'	50	40	50	30	20	20
Wimbledon Theatre	25'x23'	575	9'	45	40	50	30	20	20
Master's Boardroom	25'x14'	350	9'	N/A	N/A	N/A	N/A	12	N/A
Indy 500	25'x12'	300	9'	N/A	N/A	16	12	12	N/A
World Cup*	23'x55'	1,189	12'	115	80	120	60	40	40
Stanley Cup*	24'x55'	1,109	12'	85	70	90	50	30	30
The Plaza*	N/A	4,300	16'	500	350	500	N/A	N/A	N/A
Yacht Club*	30'x28'	840	9'	50	40	55	32	28	26
Poolside Pavilion*	N/A	2,859	16'	200	160	N/A	N/A	N/A	N/A

Dimensions outlined above are approximate. *Denotes space not shown on diagram below.

- **Parkside Grille**
Regional and American cuisine. Breakfast buffet, lunch and dinner
- **Parkside Bar**
Upscale lounge with Southwest flair
- **The Market Place**
Serving up Starbucks® Coffee, snacks and more
- Copy and printing services
- 24-hour business center
- Outdoor jogging trails
- 24-hour fitness center
- Outdoor pool & hot tub
- Room service
- Complimentary DFW International Airport Shuttle
- Free parking
- Entertainment District Trolley stop
- On-site catering
- On-site audio-visual services
- Adjacent to ACC





HILTON *Arlington*



2401 E. Lamar Blvd



ARLINGTON.ORG\MEETINGS

QUICK INFO

MEETING ROOMS

20

SQ.FT. EVENT SPACE

11,000

TOTAL ROOMS/DOUBLES

308/126

MILES TO ACC MILES TO DFW AIRPORT

1 10

- **R Bar & Grill**
Features locally sourced Texas chef-inspired cuisine. Casual yet innovative menu. Outdoor patio with firepit.

- **FIRST**
Bountiful breakfast buffet
- Newly renovated event and meeting spaces
- Concierge
- 24-hour front desk
- 24-hour business center
- 24-hour fitness center
- Free wifi access in all guest rooms
- Indoor/outdoor heated pool
- Room service
- Complimentary DFW International Airport Shuttle
- Entertainment District Trolley stop
- On-site catering and audio-visual services
- PURE™ Allergy Friendly Rooms
- Free parking

FIRST FLOOR MEETING ROOMS

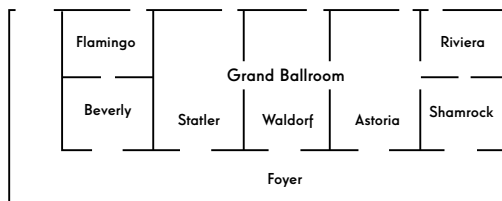

SECOND FLOOR MEETING ROOMS

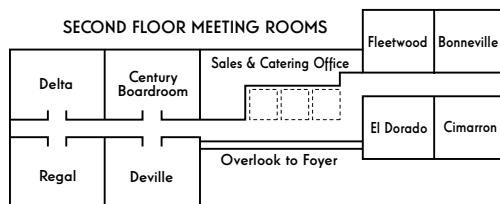

R Bar & Grill

Wood burning pizza oven along with a cocktail and craft beer program features cocktails made with fresh juices, house made bitters and mixers – something for everyone.

MEETING ROOM	L x W x H	SQ. FT.	CLASSROOM	THEATRE	BANQUET	RECEPTION	U-SHAPE	CONFERENCE
FIRST FLOOR								
Grand Ballroom	120'x42'x14'	5,040	320	600	350	500	-	-
Beverly	24'x21'x14'	504	25	50	30	50	18	20
Flamingo	24'x21'x14'	504	25	50	30	50	18	20
Statler	24'x42'x14'	1,008	60	120	70	120	30	34
Waldorf	24'x42'x14'	1,008	60	120	70	120	30	34
Astoria	24'x42'x14'	1,008	60	120	70	120	30	34
Shamrock	24'x21'x14'	504	25	50	30	50	18	20
Riviera	24'x21'x14'	504	25	50	30	50	18	20
Capitol Ballroom	90'x30'x12'	2,700	150	320	200	320	-	-
Capitol I, II or III	30'x30'x12'	900	50	100	60	110	25	30
SECOND FLOOR								
Delta	18'x24'x8'	432	24	40	30	30	18	18
Century Boardroom	12'x18'x8'	220	-	-	-	-	-	12
Regal	18'x24'x8'	432	24	40	30	30	18	18
Deville	18'x24'x8'	432	24	40	30	30	18	18
Bonneville	18'x24'x8'	432	24	40	30	30	18	18
Fleetwood	18'x24'x8'	432	24	40	30	30	18	18
El Dorado	18'x24'x8'	432	24	40	30	30	18	18
Cimarron	18'x24'x8'	432	24	40	30	30	18	18

Dimensions outlined above are approximate.



CROWNE PLAZA Hotel



700 Avenue H East



ARLINGTON.ORG/MEETINGS

QUICK INFO

MEETING ROOMS

8

SQ.FT. EVENT SPACE

8,400

TOTAL ROOMS/DOUBLES

200/57

MILES TO
ACC

2

MILES TO
DFW AIRPORT

7

- **Equinox Grill & Bar**
Regional and American cuisine. Breakfast buffet, lunch and dinner

- **Equinox Sports Bar**
Watch the game and enjoy a full bar and menu

- Gorgeous seven-story atrium

- Starbucks® Coffee bar

- Business center

- Concierge services

- Free wifi

- 24-hour fitness center

- Indoor pool & hot tub

- Room service

- Guest Laundry

- Complimentary DFW International Airport shuttle

- Entertainment District Trolley stop

- On-site catering

- On-site audio-visual services

- Free parking

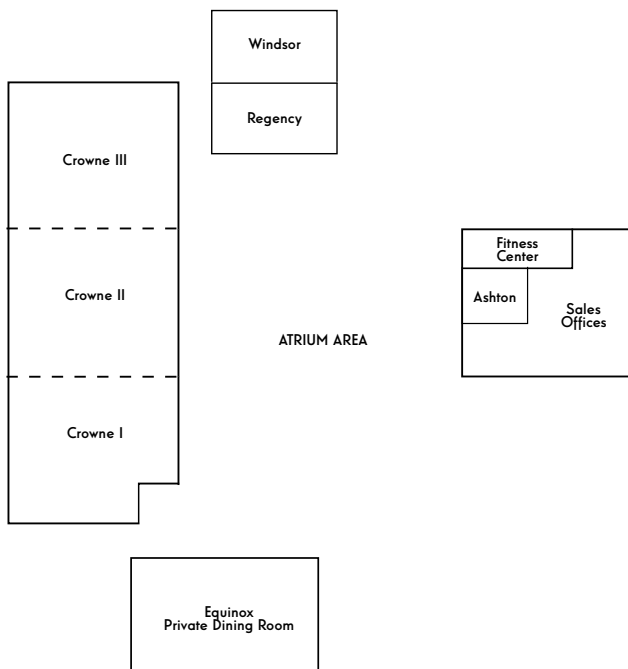

MEETING ROOM	SQ. FT.	DIMENSIONS	CLASSROOM	THEATRE	BANQUET	RECEPTION	U-SHAPE	CONFERENCE	CEILING
Crowne Ballroom	2,870	84'x35'	160	260	210	240	72	84	11'
Crowne I	1,085	33'x35'	60	98	80	100	30	30	11'
Crowne II	840	24'x35'	36	75	60	80	24	24	11'
Crowne III	945	27'x35'	48	84	70	80	24	24	11'
Regency	365	14'x24'	-	-	-	-	-	12	-
Windsor	365	14'x24'	14	20	20	-	-	12	-
Ashton	192	12'x16'	-	-	-	-	-	8	-
Equinox Private Dining Room	1,296	36'x36'	-	-	-	-	-	-	-





HOLIDAY INN *Arlington*



1311 Wet N Wild Way



ARLINGTON.ORG\MEETINGS

QUICK INFO

MEETING ROOMS

5

SQ.FT. EVENT SPACE

3,100

TOTAL ROOMS/DOUBLES

147/65

MILES TO
ACC

1.5

MILES TO
DFW AIRPORT

9

- **Sporting News Grill**
Enjoy a full-service bar and American cuisine

- 24-hour front desk
- 24-hour business center

- Free self-serve laundry options

- Free wifi

- 24-hour fitness center

- Indoor pool & hot tub

- Room service

- Complimentary DFW International Airport Shuttle

- Free parking

- Entertainment District Trolley stop

- On-site catering

- On-site event assistance

- Audio-visual services

- 100% smoke free

- Additional breakout spaces:

Board room: 20 ppl

Media room: 10 ppl

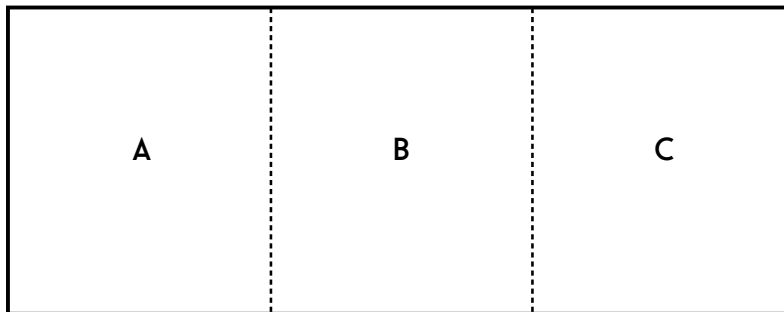

COWBOY'S BALLROOM

FUNCTION ROOM	SQ.FT.	DIMENSIONS	THEATRE	CLASSROOM	BANQUET	HOLLOW SQUARE	EXHIBITS 8X10
Ballroom	2,400	75'x30'	180	120	150	75	50
A	800	25'x30'	60	40	50	25	
B	800	25'x30'	60	40	50	25	
C	800	25'x30'	60	40	50	25	

Dimensions outlined above are approximate..





LOCATION *is everything*

ARLINGTON, TEXAS

A CONVENIENT LOCATION AND VARIED TRANSPORTATION OPTIONS ARE VALUABLE ASSETS THAT ENCOURAGE ATTENDANCE.

Because of a central location in the continental United States between Dallas and Fort Worth and a placement at the crossroads of five interstate highways, Arlington offers unparalleled accessibility.



BY AIR Arlington is 10 miles from **Dallas/Fort Worth International Airport**, the third busiest airport in the world and no more than 4 hours by air from every major city in the country. Most of our hotels offer complimentary shuttles to and from DFW Airport.

Arlington is 30 minutes from Dallas Love Field, home to carrier Southwest Airlines. The Love Field Modernization Program (LFMP) renovations are also underway: a centralized concourse with 20 gates, a remodeled lobby, expanded baggage claim area and a new ticketing wing. For corporate, cargo and recreational pilots, the Arlington Municipal Airport also offers accessibility and convenience.



BY TRAIN Amtrak operates multiple trains in the DFW area, like the Heartland Flyer out of Fort Worth and the Texas Eagle out of Dallas. The Trinity Railway Express (TRE) commuter train connects to the downtown areas of Dallas and Fort Worth, with stops at DFW Airport. Trains operate Monday through Saturday.



BY CAR Arlington sits at the crossroads of five interstate highways, making the average drive time to most major cities in the state and region approximately three to five hours.



ENTERPRISE RENT-A-CAR offers multiple locations and will even pick up your attendees. **Reference discount code # L9C1291 when booking, visit www.enterprise.com or call 817-459-4001.**



BY CAB Yellow Cab, with the largest taxi fleet in North Texas, serves the DFW area with taxi, sedan, shuttle van and limo services, 24 hours a day, 7 days a week. **For booking options, visit www.arlington.org/yellow-cab.**



BY BUS - Dan Dipert Tours & Coaches (817-654-3622) and Roadrunner Charters (972-692-5477) proudly provide motorcoaches and shuttle buses in a variety of sizes and capacities for your mass transportation needs. Whether you are planning an evening event, a spouse activity or an airport run, count on their excellent customer service free of charge. For booking options, contact jessicac@dandipert.com or donna@roadrunnercharters.com. Mention the Arlington CVB to both Dan Dipert Tours & Coaches and Roadrunner Charters.



BY TROLLEY Guests of participating hotels* receive complimentary trolley transportation to the Arlington Welcome Center, Six Flags Over Texas, Hurricane Harbor, Globe Life Park in Arlington, AT&T Stadium, plus additional shopping, dining and entertainment locations like Lincoln Square.

Complimentary trolley service is available to groups based on room night stays at participating Trolley District hotels. The ACVB staff will determine eligibility, make arrangements and oversee the schedule with the Trolley District. Contact our Services Team to qualify.

■ **Online seasonal schedule and route information:**
arlingtontrolley.com

* **PARTICIPATING TROLLEY HOTELS:** Admiral Hotel, Baymont Inn & Suites, Candlewood Suites, Courtyard by Marriott, Crowne Plaza Suites, Days Inn, Econo Lodge Inn & Suites, Fairfield Inn by Marriott, Hampton Inn & Suites, Hawthorn Suites, Hilton, Hilton Garden Inn, Holiday Inn, Holiday Inn Express, Homewood, Suites, Howard Johnson Express, Hyatt Place, Residence Inn by Marriott, Sheraton, Sleep Inn, SpringHill Suites by Marriott, TownePlace Suites by Marriott, Wingate Inn by Wyndham



HOTEL Locator Map



- | | | |
|--------------------------------------|----------------------------------|------------------------------------|
| 1 Sheraton Arlington | 15 Wingate by Wyndham | 30 Days Inn |
| 2 Hilton Arlington | 16 Homewood Suites by Hilton | 31 Howard Johnson Express Inn |
| 3 Crowne Plaza Suites | 17 Springhill Suites by Marriott | 32 Hilton Garden Inn |
| 4 Econo Lodge Inn & Suites | 18 Ranger Inn & Suites | 33 Hampton Inn & Suites |
| 5 La Quinta Inn & Suites North | 19 Candlewood Suites | 34 Residence Inn by Marriott South |
| 6 Courtyard by Marriott | 20 Blue Cypress Hotel | 35 Courtyard by Marriott South |
| 7 Quality Inn at Arlington Highlands | 21 Fairfield Inn by Marriott | 36 Comfort Suites |
| 8 Hawthorn Suites | 22 Townplace Suites by Marriott | 37 Admiral Hotel |
| 9 La Quinta Inn & Suites South | 23 Sanford House Inn & Spa | 38 Parkway Inn |
| 10 Hyatt Place | 24 Knights Inn | 39 Super 8 |
| 11 Residence Inn by Marriott | 25 Sleep Inn | 40 The Thorton Inn |
| 12 Holiday Inn Express North | 26 Best Western Inn & Sites | 41 Microtel Inn by Wyndham |
| 13 Hampton Inn & Suites | 27 Inn Town Suites | 42 Quality Inn North |
| 14 Baymont Inn & Suites | 28 Days Inn | 43 Days Inn |
| | 29 Holiday Inn | |

SELECT AND LIMITED SERVICE HOTELS

HOTEL KEY

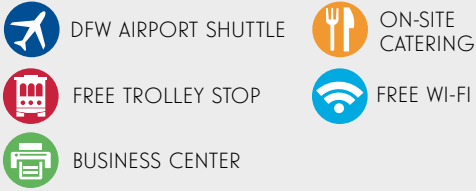

ROOMS

CONFERENCE/MEETING FACILITIES

TRAVEL

		TOTAL ROOMS	DOUBLES	# OF COMMITTABLE ROOMS	TOTAL SQ.FT. MEETING/EXHIBIT	# OF MEETING ROOMS	BANQUET CAPACITY (#PPL)	THEATER CAPACITY (#PPL)	CLASSROOM CAPACITY (#PPL)	DISTANCE TO ACC (MILES)
Admiral Hotel 1507 N Watson		237	147	200	4048	5	275	400	200	2
Baymont Inn & Suites 2401 Diplomacy Dr		95	55	60	400	1	26	26	26	1
Best Western Cooper Inn & Suites 4024 Melear Dr.		65	38	66	0	0	0	0	0	7.3
Blue Cypress Hotel 117 S. Watson Rd.		192	96	100	9500	2	790	1055	400	2
Candlewood Suites Arlington 2221 Brookhollow Plaza Drive		125	0	30	0	0	0	0	0	1.5
Comfort Suites Arlington 411 W. Rd. to Six Flags Dr.		108	44	60	2500	2	60	70	75	1.5
Courtyard by Marriott 1500 Nolan Ryan Expy		147	95	30	1300	2	40	40	30	0.2
Courtyard by Marriott South 711 Highlander Boulevard		103	45	50	1879	3	90	130	40	7.5
Days Inn South 1901 W. Pleasant Ridge Rd.		47	21	30	0	0	0	0	0	12.2
Days Inn 910 North Collins Street		92	77	30	0	1	10	10	10	1
Days Inn Six Flags Mall 3501 East Division Street		112	40	40	0	1	28	28	28	2.7
Econo Lodge Inn & Suites 1075 Wet N Wild Way		130	62	62	1040	2	35	70	60-75	1.5
Fairfield Inn & Suites by Marriott 2500 East Lamar Blvd		101	45	20	0	1	12	12	12	1.3
Hampton Inn & Suites Arlington South 1100 East I-20		98	31	50	1120	2	64	70	50	7
Hampton Inn & Suites 2200 Brookhollow Plaza Drive		103	30	20	1456	3	40	35	30	1
Hawthorn Suites by Wyndham 2401 Brookhollow Plaza Dr		129	26	70	861	2	30	45	30	1
Hilton Garden Inn 2190 E. Lamar Blvd		132	67	60	1702	4	2,472	150	120	1
Holiday Inn Express & Suites 2451 East Randol Mill Rd.		103	65	30	2418	2	56/25	65/35	50/25	1
Homewood Suites by Hilton 2401 Rd. to Six Flags Street East		89	89	39	294	1	18	25	18	1.5



HOTEL KEY

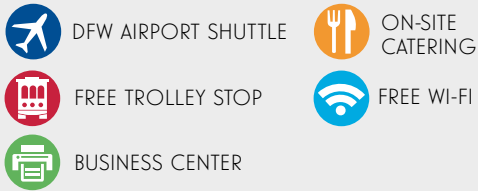

				ROOMS			CONFERENCE/MEETING FACILITIES					TRAVEL
				TOTAL ROOMS	DOUBLES	# OF COMMITTABLE ROOMS	TOTAL SQ. FT. MEETING/EXHIBIT	# OF MEETING ROOMS	BANQUET CAPACITY (#PPL)	THEATER CAPACITY (#PPL)	CLASSROOM CAPACITY (#PPL)	DISTANCE TO ACC (MILES)
Howard Johnson Express Inn 2001 East Copeland Rd.				98	67	VARIABLES	0	0	0	0	0	0.6
Hyatt Place Arlington 2380 E Rd. to Six Flags				127	58	76	1200	2	50	60	50	0.2
InTown Suites 2211 North Collins				133	30	0	0	0	0	0	0	2.4
Knights Inn 820 N. Watson Rd				114	50	10	0	0	0	0	0	1
La Quinta Inn & Suites Six Flags Drive 825 North Watson Rd.				178	90	30/60	4400	5	200	350	240	1
La Quinta Inn & Suites South 4001 Scots Legacy Dr.				128	86	25	700	1	35	40	25	9.9
Microtel Inn 1740 Oak Village Blvd				42	19	20	0	0	0	0	0	12
Parkway Inn 703 Bengé Dr				60	35	7	0	0	0	0	0	3
Quality Inn at Arlington Highlands 121 East I-20				128	68	40	525	1	0	35	20	6
Ranger Inn & Suites 800 Six Flags Drive				40	20	10	0	0	0	0	0	0.8
Residence Inn by Marriott 1050 Brookhollow Plaza Dr.				114	24	40	650	1	40	40	24	1
Residence Inn by Marriott South 801 Highlander Blvd				96	7	30	1024	2	60	90	30	7.5
Sanford House Inn & Spa 506 N. Center St.				12	2	NA	2370	1	50	60	40	2.3
Sleep Inn Maingate 750 Six Flags Drive				126	60	10 OR MORE	0	0	0	0	0	0.8
SpringHill Suites by Marriott 1975 East Lamar Blvd				121	44	100	350	1	0	35	24	1.3
Super 8 2712 E Abram St				50	20	10	0	0	0	0	0	1.5
The Thornton Inn B&B 719 W Abram St				5	1	NA	33	1	15	0	12	3.2
TownePlace Suites by Marriott 1709 East Lamar Blvd				94	22	60	0	0	0	0	0	1.1
Wingate by Wyndham 1024 Brookhollow Plaza Dr				92	23	NA	650	2	25	40	35	1.5

UNIQUE Venues

“We connect meeting professionals with an array of unique venues and elite services, as well as unmatched entertainment options.”

– Ellen Brown, Director National Accounts



HOWELL FAMILY FARMS • 4016 WEST DIVISION ST.

Historically-registered cottage and barn offering a secluded feel with all the “big city” comforts like crystal chandeliers. Cottage with a wrap-around porch, stone ceremony stage, baseball outfield (able to accommodate a very large tent), or Barn: Upstairs reception room is 70' x 40' and downstairs area: 70' x 15'.

SEATED DINNER	200
COCKTAILS	300
DINNER/DANCE	180
DOWNSTAIRS	46-80

AV, tables & chairs, valet parking, ability to bring in offsite catering



THE SANFORD HOUSE INN & SPA • 506 N. CENTER ST.

Magnificent Bed & Breakfast, Restaurant, Bar, Spa, Salon & Event Facility. The elegant house is nestled into an outdoor grand courtyard, blooming with flowers and shaded by majestic trees.

LARGE PAVILION AND GAZEBO	200
RENOIR ROOM	50
RESTAURANT	70

Custom menu from Executive Chef, AV, complimentary wifi



1010 COLLINS ENTERTAINMENT • 1010 N. COLLINS ST.

Tailgate and celebrate in the Entertainment District, across from AT&T Stadium, 18,000+ sq.ft. of interior event space. Tables, chairs, drapes and centerpieces, three high-definition presentation screens, mood lighting, AV.

DINNER/DANCE	800
RECEPTION	1,000
CLASSROOM	1,500
THEATRE	2,000
OUTDOOR GARDEN	3,000
INDOOR ROOM	
200 dinner, 250 classroom	
300 theatre	



CACHAREL RESTAURANT & GRAND BALLROOM

2221 E. LAMAR BLVD. BROOKHOLLOW • TOWER 2, 9TH FL

An exquisite dining experience with unique views of Arlington's Entertainment District. Our chefs create amazing dishes and offer an extensive array of menu items along with the best steak and wine selections. Private VIP Room with seating for 12. Custom menu options from Executive Chef, AV.

GRAND BALLROOM 6,500 SQ.FT.
SEATS W/DANCE FLOOR 375,
COCKTAIL 450, THEATRE 400
CLASSROOM 200

PANORAMIC ROOM 2,200 SQ.FT.
SEATS W/DANCE FLOOR 100,
COCKTAIL 125, THEATRE 75
CLASSROOM 50



LONE STAR PARK • 1000 LONE STAR PARKWAY

Host up to 10,000 attendees with the heart-pounding excitement of live thoroughbred racing. Luxurious Penthouse Suites with spectacular views of the track. Silks Dining Room accommodates up to 1,200. Rentals include tables and chairs, linens, full catering menu and AV.

GRANDSTAND	280,00 SQ.FT.
SILKS DINING ROOM	1,200
18 LUXURY SUITES	20-50
EA DASH FOR CASH	50-250
ALYSHEBA ROOM	100-350
VIP LOUNGE	100-150



INTERNATIONAL BOWLING MUSEUM & HALL OF FAME TRAINING & RESEARCH CENTER • 621 SIX FLAGS DR.

Groups from 20-400 come alive at our International Bowling Museum & Hall of Fame. Journey back to where bowling began. Discover an interactive museum brimming with one-of-a-kind bowling artifacts and a cutting-edge glimpse at the far-flung future of this global pastime. Individual, group, and team lessons with Team USA coaches (1-15 bowlers), AV, wifi, ADA accessible.

18,000 SQ.FT. of usage space
2 breakout rooms, mini movie theater, prep kitchen, offsite catering allowed.

24,000 SQ.FT. training venue with sound system. 20 state-of-the-art lanes with projectors and screens. 16 training cameras, pro-shop, weight room.



EVENT Venues

>>> Lake Arlington PHOTO: Dan Pope

LAKE HOUSE AT LAKE ARLINGTON • 6300 W. ARKANSAS LN.

DETAILS: Open catering policy, beautiful lakeside venue, 15 tables, 65 chairs, kitchen available

MEETING ROOMS	1
CAPACITY BANQUET	60
CAPACITY THEATER	80
SQFT	1,196

K1 SPEED ARLINGTON • 1801 E. LAMAR BLVD.

DETAILS: Tables, chairs and linens included, excellent AV, wifi, offsite catering allowed

MEETING ROOMS	2
CAPACITY BANQUET	60
CAPACITY THEATER	80
SQFT	1,850

ARLINGTON MUSEUM OF ART • 201 W. MAIN ST.

DETAILS: Offsite catering allowed, flexible floor plan allowing for multiple configurations and options, kitchen facilities available

MEETING ROOMS	3
CAPACITY BANQUET	350
CAPACITY THEATER	500
SQFT	7,000

SOUTH STREET PATIO • 401 E. SOUTH ST.

DETAILS: Full-service bar, custom catering, additional 2,500 sq.ft. of covered patio, performance stage with a 'state-of-the-art' sound system and lighting

MEETING ROOMS	2
CAPACITY BANQUET	400
CAPACITY THEATER	600
SQFT	8,000

CHAMAS DO BRAZIL STEAKHOUSE • 4606 S. COOPER ST.

DETAILS: Newly-opened authentic Brazilian steakhouse, fine dining, impeccable service

MEETING ROOMS	3
CAPACITY BANQUET	40
CAPACITY THEATER	60
SQFT	940

TIERRA VERDE GOLF CLUB • 7005 GOLF CLUB DR.

DETAILS: Full-service restaurant and bar for events, award-winning golf course, stunning vistas, indoor and outdoor patio options

MEETING ROOMS	2
CAPACITY BANQUET	200
CAPACITY THEATER	275
SQFT	3,200

BOB DUNCAN • 2800 S. CENTER ST. (IN VANDERGRIF PARK)

DETAILS: Caterer's kitchen, onsite and off-site catering options, tables & chairs included, excellent AV

MEETING ROOMS	4
CAPACITY BANQUET	300
CAPACITY THEATER	500
SQFT	7,500

UT ARLINGTON - BLUEBONNET BALLROOM • UT ARLINGTON CAMPUS

DETAILS: Inhouse catering, ballroom can be divided into smaller rooms

MEETING ROOMS	1
CAPACITY BANQUET	500
CAPACITY THEATER	900
SQFT	10,640

RIVER LEGACY PARK • 701 NORTHWEST GREEN OAKS BLVD.

DETAILS: Scenic outdoor pavillions and flexible indoor options, adjacent 1,300-acre park and the Trinity River

MEETING ROOMS	FLEX
CAPACITY BANQUET	150
CAPACITY THEATER	250
SQFT	FLEX

RIPLEY'S BELIEVE IT OR NOT! ODDITORIUM • 601 E. PALACE PARKWAY

DETAILS: Unique venue with multiple attractions under one roof: wax museum maze and more. Tables and chairs, offsite catering allowed

MEETING ROOMS	FLEX
CAPACITY BANQUET	125
CAPACITY THEATER	125
SQFT	8,000

F&V Local Flavors

If you like entertaining your taste buds, let's just say that our city is your oyster. Arlington boasts one of the most diverse culinary scenes in Texas. Who doesn't love a little local fare. Check out some of our staff favorites:



Staff Picks



AL'S HAMBURGERS 1001 NE GREEN OAKS BLVD SUITE #103

Check out local staple Al's Hamburgers, established in 1957, in Northeast Arlington for seriously delicious local fare. Cut to order fries, made from scratch cheesecake and of course, Al's famous burgers.

"You can't go wrong with a cheeseburger and fries. Plus, the money's right!"

– Kelly, Convention Sales
Administrative Assistant



ARLINGTON STEAK HOUSE 1724 W. DIVISION ST.

Originally called the Triangle Inn, Arlington Steak House is the oldest restaurant in Arlington, boasting a rich history in the 1930's when Top O'Hill Casino regulars would eat after a day of illegal gambling.

"Possibly the best Chicken Fried Steak that I have ever had. And I would be perfectly happy making a meal of the rolls and green beans alone."

– Michael, Digital Marketing Manager



BABE'S CHICKEN DINNER HOUSE 230 N. CENTER ST

Have you ever seen a giant mountain of delicious fried chicken? Come to Babe's, where you get a family-sized portion for the whole family to share. Make sure to save room for a mandatory slice of one of their out-of-this-world pies.

"I always get the chicken tenders with a side of gravy for dipping, and I could eat the whole bowl of corn by myself...good biscuits too!"

– Cynthia, Executive Assistant



CATFISH SAM'S 2735 W. DIVISION ST.

Catfish with all the fixin's? You got it. But don't fill up on the plentiful pre-meal set up. Their catfish is the main attraction.

"Fried catfish (regular) is my favorite. They have a 'setup dish' that is free with a meal, but it is a meal in itself – hush puppies, beans, onions, peppers."

– Joel, VP, Finance & Administration



DAVID'S BBQ 2224 W. PARK ROW DR., SUITE H

From the fall-off-bone ribs to the deliciously seasoned and carefully cooked pulled pork, it's a no-brainer for those traveling with a craving for some top-notch Texas barbeque. They also sell Mindy Lu's fried pies—an Arlington original and favorite.

"It's a barbeque joint, so I would choose the two meat entrée, brisket and turkey. Say hello to Owner Jimmy Harris and save room for the complimentary soft serve ice cream cones after your meal."

– David, Sr. Director of National Accounts



EL GABACHO TEX MEX GRILL 2408 W. ABRAM ST.

Not only is the atmosphere inviting, but El Gabacho delivers on the Tex-Mex experience. Don't forget the margaritas in strawberry and swirl!

"The sour cream chicken chile relleno is ridiculously good. You get a huge plate of food, and the chips & salsa are unique there... warm salsa."

– Matt, Director of Sports





FORK IN THE ROAD
1821 S. FIELDER RD.

One word: Crack-a-Roni. The savory blend of truffle oil and multiple cheese will melt in your mouth or try Arlington Today's 2014 "Favorite Hamburger" Reader's Choice.

"Get there early for lunch, it's small and fills up fast. The grilled cheese sandwich is amazing and the mac'n cheese is out of this world."

— Jon, Vice President, Sales



OLENJACK'S GRILLE
70 E. RD. TO SIX FLAGS #100

Chef Brian Olenjack serves up casual fine dining and sophisticated Texas-Inspired flavors like Shrimp & Grits, Goat Cheese Grits & Ancho Pulled Pork. The covered patio and private dining room accommodate up to 215 guests.

"The Sweet Potato Polenta and Grape Tomato Bruschetta are must-haves. I always save room for the Crème Brulee Trio."

— Lisa, Project Manager



PICCOLO MONDO
829 E. LAMAR BLVD.

Fine dining is better with someone special or a group of friends. Enjoy the ambiance and live piano music as you savor homemade Italian food like the Gnocchi al Pomodoro or Veal Parmigiana.

"I always ask them to make the tomato sauce more spicy for the Gnocchi."

— Neetu, Partnerships



PRINCE LEBANESE GRILL
502 W. RANDOL MILL RD.

If you want Mediterranean food in Arlington, look no further than Prince, with authentic gyros, shawarma, falafel, tzatziki, baklava and much more. **Food Network's 'Diners, Drive-Ins & Dives'** brought food aficionado Guy Fieri to Arlington just to try it—look for his graffiti on the wall.

"The chicken shawarma is awesome! The family that owns and operates the restaurant are great folks and do an amazing job making you feel at home."

— Ronnie, President & CEO



PULIDO'S MEXICAN CAFÉ
3330 MATLOCK RD.

Stop by Pulido's for deliciously convenient Tex-Mex food at a great price. Plus, they have a \$4.99 enchilada dinner every Monday.

"It is family owned and has been in Arlington for a very long time. I recommend their taco salad and quesadillas."

— Shelley, Admin. & HR Assistant



TASTE OF EUROPE
1901 W. PIONEER PKWY.

Provoke your tastebuds and don't be afraid to try something new. Taste of Europe is an authentic Russian restaurant with a built-in grocery/deli. **Food Network's 'Diners, Drive-Ins & Dives'** brought food aficionado Guy Fieri to try the authentic and delicious borscht, stuffed cabbage and beef stroganoff.

"The owners are awesome, and the food is one-of-a-kind. Find salamis and hard to find types of cheeses in the deli."

— Decima, Sr. Director of Marketing & Public Relations



TRAIL DUST STEAK HOUSE
2300 E. LAMAR BLVD.

Trail Dust's unique atmosphere is a taste of Texas. Saddle up for juicy steaks, chicken, baked potatoes and more. Enjoy a two-story slide and dance floor where you can enjoy live music (call for schedule). Take that necktie off before you go...they'll cut it off!

"The food is delicious, but I really love the atmosphere. The restaurant looks like a red barn."

— Jason, Graphic Designer

After

5

>>> Dave and Buster's Pool Room

LIGHT UP THE NIGHT with live music, comedy, pubs, karaoke bars and more. Sample a local beer from Humperdink's award-winning brewery. Or sing along with your friends at Louie Louie's Dueling Piano Bar. Whether you want to dress up or scoot a boot, you'll find a vibrant scene to entertain you. Take off your tie! Arlington awaits.

- **ALLEY CATS ENTERTAINMENT CENTER** | 2008 W. Pleasant Ridge Rd.
Mon-Thurs 9 am-midnight, Fri-Sat 9 am-2 am, Sun 10 am-midnight
>>> *Bowling, laser tag, putt-putt golf, rock climbing, batting cages, arcade, billiards, bar and restaurant*
- **ANTONIO'S MEXICAN RESTAURANT** | Lincoln Square Shopping Center
HOURS: Sun-Thurs 11 am-9 pm, Fri-Sat 11 am-11 pm >>> *Karaoke Thur - Sat*
- **ARLINGTON IMPROV & BLACK DOG PIZZA** | Arlington Highlands
Wed 6 pm-11 pm, Thurs 4:30 pm-10 pm, Fri-Sat 11 am-2 am, Sun 12 pm-midnight
- **BLUE MESA GRILL** | 550 Lincoln Square
Mon-Thurs 11 am-10 pm, Fri-Sat 11 am-11 pm, Sun 9 am-10 pm
Bar open until 2 am Thurs-Sat >>> *Known for an extensive tequila selection*
- **BOOMERJACK'S GRILL & BAR** | two locations
Lincoln Square Shopping Center & Arlington Highlands Shopping Center
Mon-Sun 10:30 am-2 am
- **BOSTON'S SPORTS BAR** | 2501 E. Lamar Wed-Sun-11 am-1 am, Thu-Sat 11 am-2 am
- **DAVE & BUSTER'S** | Arlington Highlands Shopping Center
Sun-Thur 11 am-midnight, Fri-Sat 11 am-1 am
- **HOOLIGANS PUB** | 310 E Abram St #150 (Downtown Arlington)
Monday - Friday 4 pm-2:30 am, Sat-Sun 2 pm-2:30 pm
- **HUMPERDINK'S RESTAURANT & BREW PUB** | 700 Six Flags Drive
Mon-Sun 11 am-2:00 am >>> *Microbrewery*
- **J. GILLIGAN'S BAR & GRILL** | 400 E. Abrams (Downtown Arlington)
Mon-Sun 10 am-11 pm, Fri-Sat 10 am-12 am
>>> *As seen on the Travel Channel, invented the Irish Nacho*
- **K1 SPEED INDOOR RACING** | 1801 E. Lamar Blvd.
Mon-Thurs noon-10pm, Fri 11 am-11 pm, Sat 10 am-11 pm, Sun 10 am-8 pm
- **LOUIE LOUIE'S DUELING PIANO BAR** | Lincoln Square Shopping Center
Wed-Sat 7 pm-2 am
- **MELLOW MUSHROOM** | 200 N Center St. Sun-Thurs 11am-9pm, Fri-Sat 11am-10 pm
>>> *One of the widest beer tap selections in town*
- **THE MELTING POT FONDUE RESTAURANT** | 4000 Five Points Blvd., Ste.119
Mon-Thurs 5 pm-10 pm, Fri 5 pm-11 pm, Sat 3:30 pm-11 pm, Sun 3 pm-9 pm
>>> *Selection of more than 100 wines*
- **PERFECTO CIGAR SHOP & LOUNGE** | Lincoln Square Shopping Center
Mon-Thurs 10 am-10 pm, Fri-Sat 10 am-midnight, Sun noon-6 pm
- **PIRANHA KILLER SUSHI** | two locations >>> *Extensive martini list*
859 N.E. Green Oaks Blvd. and 309 Curtis Mathes Way, #149
- **SHERLOCK'S BAKER STREET PUB & GRILL** | Lincoln Square Shopping Center
Mon-Sun 11 am-2 am



Top 10 reasons to select Arlington for your next event.

- 1) **ONE WORD: ACCESSIBILITY!** – Few destinations are as traveler-friendly as Arlington. DFW International Airport serves more than 24 scheduled airlines, providing non-stop service from more than 200 U.S. domestic and international cities combined.
- 2) **CHAMPAGNE TASTE ON A BEER BUDGET** – Have a ‘different’ budget or meeting size? Give us a try. Compared to other U.S. destinations, you’ll find Arlington accommodations and venues are among the best deals.
- 3) **WE WORK FOR “HIGH-FIVES”** – Imagine having a team of experts dedicated to your event and its success. Answering your questions. Trouble-shooting your needs. How much would you pay for this? Put your wallet away...our priceless services are complimentary to meeting and event planners that utilize hotel rooms in Arlington.
- 4) **PERSONALIZED SERVICE** – We’ve made a reputation of taking every client’s vision and making it happen. Don’t doubt the talent! Our VP of Convention Services once wrangled a live boxing kangaroo for a client’s event. Ka-pow!
- 5) **HOTEL BLOCKS** – No need to call around town to determine pricing when we can help you gather room block pricing. Talk about one-stop-shopping!
- 6) **DID SOMEBODY SAY SHOPPING??** – Can shopping solve all the world’s problems? Maybe. Looking fabulous at your meeting or convention is a good place to start. Arlington offers amazing retail therapy—the Parks at Arlington Mall, Arlington Highlands, Grand Prairie Premium Outlets are within 5 short miles of each other. Let the healing begin.
- 7) **MORE TO A MEETING THAN A MEETING** – Hear the crack of the bat at Globe Life Park, take a whirl on a roller coaster, dine in a rustic barn...Arlington is all about experiences. Go on and brag to your friends and make ‘em ask “do you ever work?”
- 8) **PLANES, TRAINS, AUTOMOBILES...AND TROLLEYS** – We’re perfectly situated next to DFW International Airport, and our Services team is ready and willing to help you and your group/attendees get where they need to be. Need a party bus, stagecoach or our friendly neighborhood Arlington Trolley? They will pull out the stops, no pun intended, to get your group rolling (pun intended).
- 9) **CURE FOR THE THE HICCUPS** – Questions because something unexpected has happened to your event plans? We are a phone call away with vendor support and logistic suggestions to keep things on track.
- 10) **WE’RE NATURALLY BEAUTIFUL** – Breaktime! Stretch your legs and refocus beside the ACC’s scenic lake. Or burn off the ACC’s decadent bread pudding on the adjacent outdoor walking trails. Arlington boasts River Legacy Park, which is a 1,300-acre urban oasis that follows the scenic Trinity River. And it’s hard to find a more beautiful course than the award-winning Tierra Verde Golf Club. We have the nifty Audubon-Society sanction to prove it.

The Enterprise Way

Need a rental?

Whether you need a car, truck or 15 passenger van,
Enterprise is the perfect choice. And, we'll pick your customers up.

*Reference discount code # **L9C1291** on your next rental.*

*For more information, visit www.enterprise.com
or call (817)459-4001 to speak with a representative.*



We'll pick you up.®

Pick-up subject to geographic and other restrictions. Enterprise, We'll Pick You Up and the "e" logo are registered trademarks of Enterprise Rent-A-Car. All other marks are the property of their respective owners. ©2014 Enterprise Rent-A-Car F00735 09.14